

## Instructions for assembly Lowered brake U2

How to lower your one-hand brake:

1. Dismantle the brakes from your chair.
2. Start on the brake handle side of the brake. Replace the bolts on your brakes with bolts (3 and 4) as shown in figure 1.
3. Before tightening the new bolts, place the spacers (1) and washers (2) on the correct side as shown in the diagram. Figure 1.
4. Tighten the bolts on this side of the brake.
5. Continue to do the same on the other side of the brake. See figure 2.

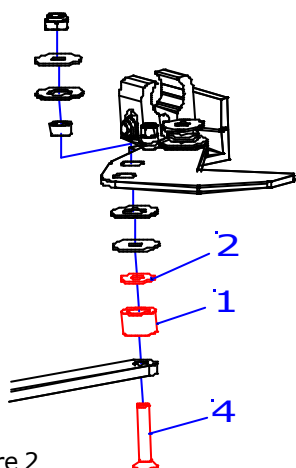
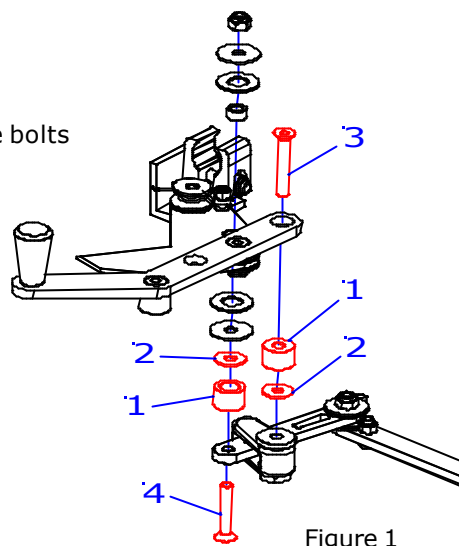

Figure 2

6. Loosen the bolt here and replace it with the new one (4), placing a spacer (1) and a washer (2) in between.
7. Tighten the new bolt.
8. The lowered brakes should now be as shown in figure 3.
9. Attach your brakes to the chair in the same way and in the same position as they were before.

**These details are included in the lowering kit for one-hand brakes:**

Lowering kit one-hand brake U2	366 00 70
1. 3 Intermediate bushings	443 00 51
2. 3 Washers 16x6x1	800 06 16
3. 1 Bolt MF6S M6x35	600 76 35
4. 2 Bolts MF6S M6x30	600 76 30

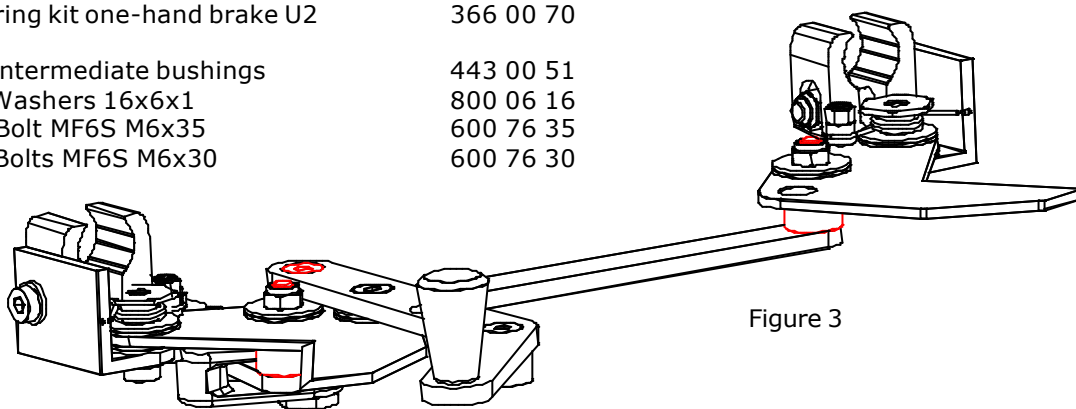

Figure 3