

Instructions for assembly Footplate

Assembly:

1. Place clamp (2) and clamp (3) around the chassis of the wheelchair as shown in figure 1.

2. Take the footplate (1) and insert the bolts (4 and 5) and washers (6) in the front or rear holes on the side of the foot plate depending on how far forward you wish to have it.

3. Screw the foot plate around the chassis tubing using the washer (6) and nut (7). Screw the bolts in loosely.

4. Repeat this procedure on the other side of the foot plate.

5. Since you have screwed in the bolts loosely it will now be possible to adjust the height of the foot plate. Move the foot plate up and down until you find a position that suits you.

6. Screw the bolts in securely.

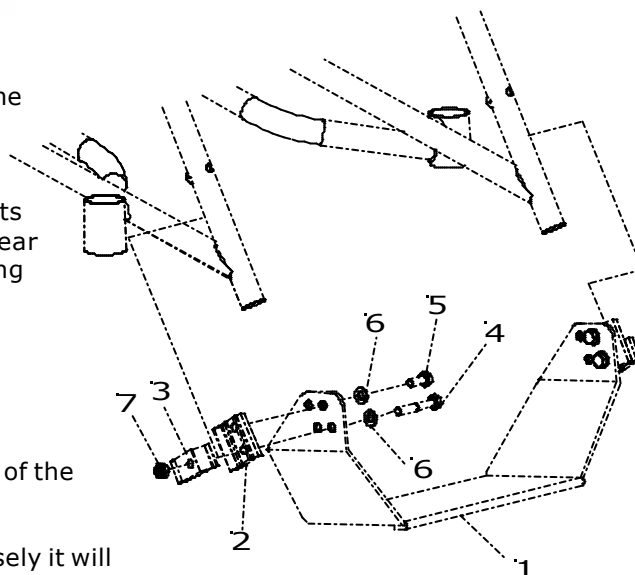

Figure 1

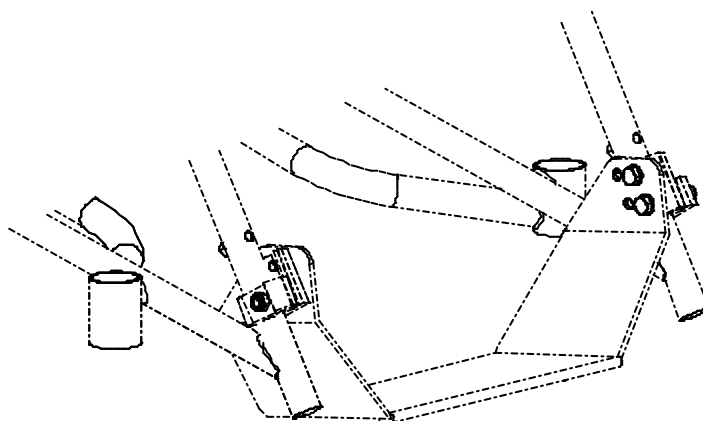

Figure 2