

Instructions for assembly Armrests high chair

How to assemble your armrests:

1. Check that you have received all the parts on the list below.
2. Start by exchanging the spacers on the nut casings for the enclosed 16mm spacers (the spacer with 3 lines). This is done to move the rear wheel out a little on each side to provide space for the armrest mountings.
3. Loosen the nut (1) in the nut casing (2) as shown in **figure 1**.
 - Unscrew the nut casing and insert the 16mm spacer.
 - Tighten the nut casing
 - Tighten the nut**(It is important to do this in the correct order).**

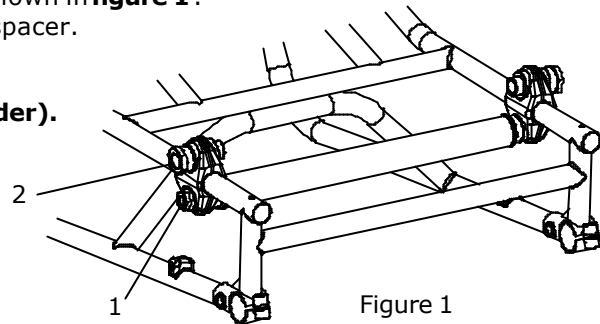

4. Assemble the mountings separately as shown in **figure 2**.
(The upper bolt with the six cornered head should be situated closest to the back on both sides).
5. Push the armrest down into the mounting. (**Figure 3**)
6. Tighten the bolt with the **six cornered head hard** and the bolt with the **socket head cap loosely**.
7. Adjust using the socket head cap so that the side guard can be easily slotted in and removed. (**Figure 3**)

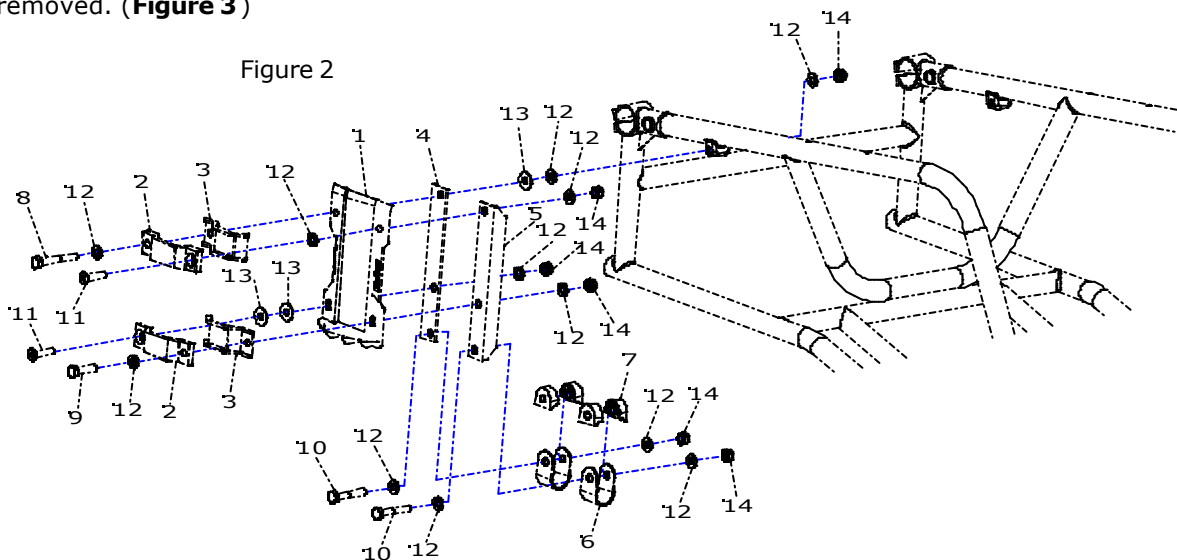

Please turn over!

panthera

Panthera Production AB
Gunnebogatan 26, 163 53 Spånga, Sweden
Tel: +46 (8) 761 50 40 Fax: +46 (8) 621 08 10
panthera@panthera.se www.panthera.se

Instructions for assembly Armrests high chair

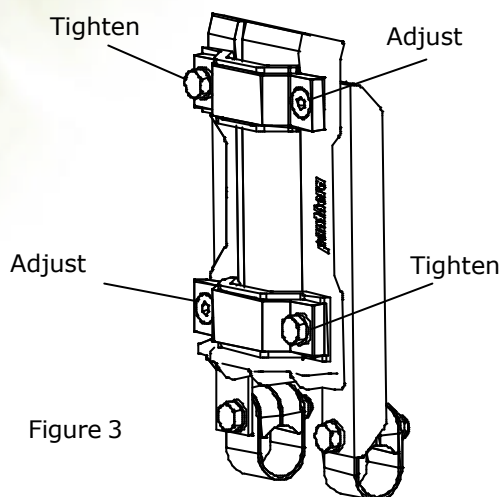

Figure 3

This assembly unit contains

- 1 Armrest (left)
- 1 Armrest (right)

Alternative

- 1 Armrest (left) raised 35mm
- 1 Armrest (right) raised 35mm

2 Spacer nut casings 16mm

Details in the enlarged diagram (Figure 2)

- 1. 2 Armrest mountings, plastic
- 2. 4 Armrest mounting clamps
- 3. 4 Armrest bushings
- 4. 2 Mounting plates for armrest high chassis left
- 5. 2 Mounting plates for armrest high chassis right
- 6. 4 Reinforcement supports
- 7. 8 Mid section armrest clamps
- 8. 2 Bolts M6S M6x45
- 9. 2 Bolts M6S M6x25
- 10. 4 Bolts M6S M6x35
- 11. 4 Bolts MF6S M6x25 (recessed socket)
- 12. 24 Washers 6x12
- 13. 6 Washers 6x16
- 14. 12 Locking nuts M6 low

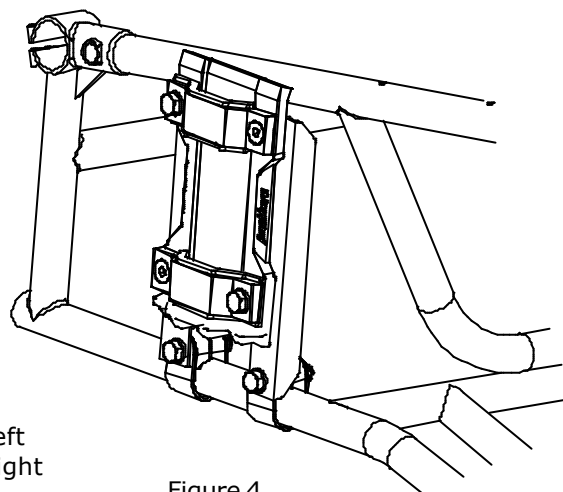

Figure 4