

Instructions for assembly Armrests

How to assemble your armrests:

1. Check that you have received all the parts on the list below.
2. Start by exchanging the spacers on the nut casings for the enclosed 16mm spacers (the spacer with 3 lines). This is done to move the rear wheel out a little on each side to provide space for the armrest mountings.
3. Loosen the nut (1) in the nut casing (2) as shown in figure 1.
 - Unscrew the nut casing and insert the 16mm spacer.
 - Tighten the nut casing
 - Tighten the nut(It is important to do this in the correct order).

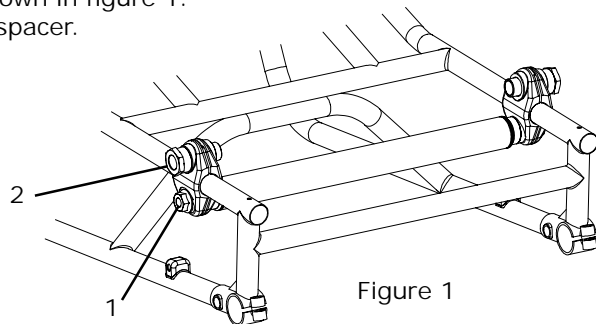

Figure 1

4. Assemble the mountings separately as shown in figure 2.
(The upper bolt with the six cornered head should be situated closest to the back on both sides).
5. Push the armrest down into the mounting. (Figure 3)
6. Tighten the bolt with the six cornered head hard and the bolt with the socket head cap loosely.
7. Adjust using the socket head cap so that the side guard can be easily slotted in and removed. (Figure 3)

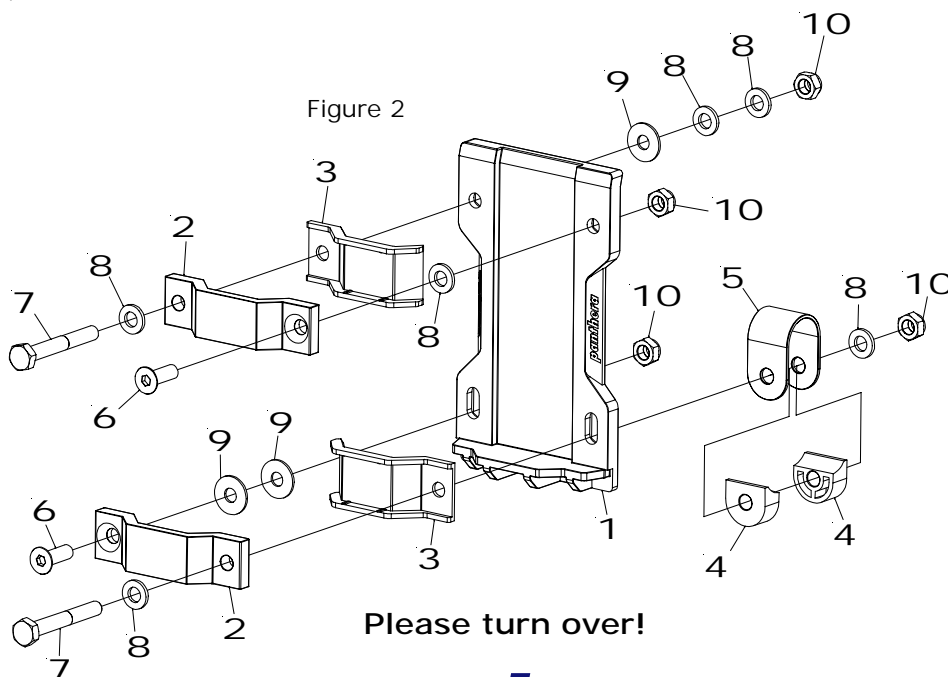

Figure 2

Please turn over!

panthera

Panthera Production AB
Gunnebogatan 26 , 163 53 Spånga , Sweden
Tel: +46 (8) 761 50 40 Fax: +46 (8) 621 08 10
panthera@panthera.se www.panthera.se

Instructions for assembly Armrests

This assembly unit contains

- 1 Armrest (left)
- 1 Armrest (right)

Alternative

- 1 Armrest (left) raised 35mm
- 1 Armrest (right) raised 35mm

- 2 Spacer nut casings 16mm

Details in the enlarged diagram (Figure 2)

1. 2 Armrest mountings, plastic
2. 4 Armrest mounting clamps
3. 4 Armrest bushings
4. 4 Mid section armrest clamp
5. 2 Reinforcement supports
6. 4 Bolts MF6S M6x18 (recessed socket)
7. 4 Bolts M6S M6x45
8. 12 Washers 6x12
9. 6 Washers 6x16
10. 8 Locking nuts M6 low

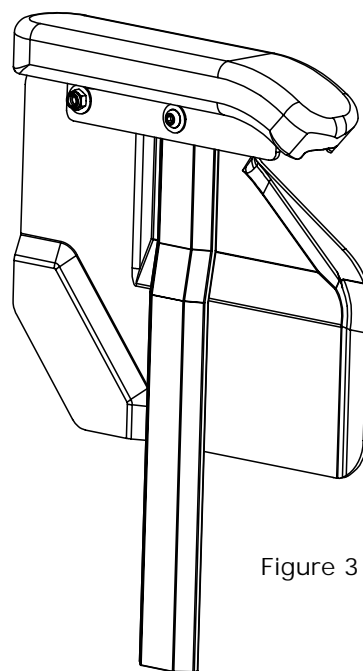

Figure 3

