

Instructions for assembly Anti tip device Basket

How to assemble your Basket anti tip device:

This construction is based on screwing in the bolts from underneath (as shown in figure 1) for easier access. For this reason the clamps round the back axle will be attached in a different way to your current method.

1. Remove the rear wheels.

2. Loosen the bolts holding the section with the clamps round the back axle. (These bolts are not needed for assembling the tip stop.)

3. Then remove what is currently the top clamp (K1) (above the chassis tubing) and exchange this for clamp 8. Leave the other pieces above the back axle in place. (See figure 1)

4. Take clamp 7 and place it under the back axle. (figures 1 and 2)

5. Place the curved tubing (1) beneath the clamp (7). (figure 2)

6. Now place the clamp (K1) under the curved tubing.

7. Take the bolts (6) and washers (5) you have received from us and screw these in from underneath. (As shown in figure 2)

Camber axle without anti tip device

This clamp (K1) is exchanged for clamp 8 in figure 2.

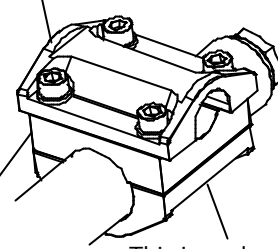

The pieces between the clamp (K1) and the back axle can be left as they are. This is replaced by clamp 7, figure 2.

Figure 1

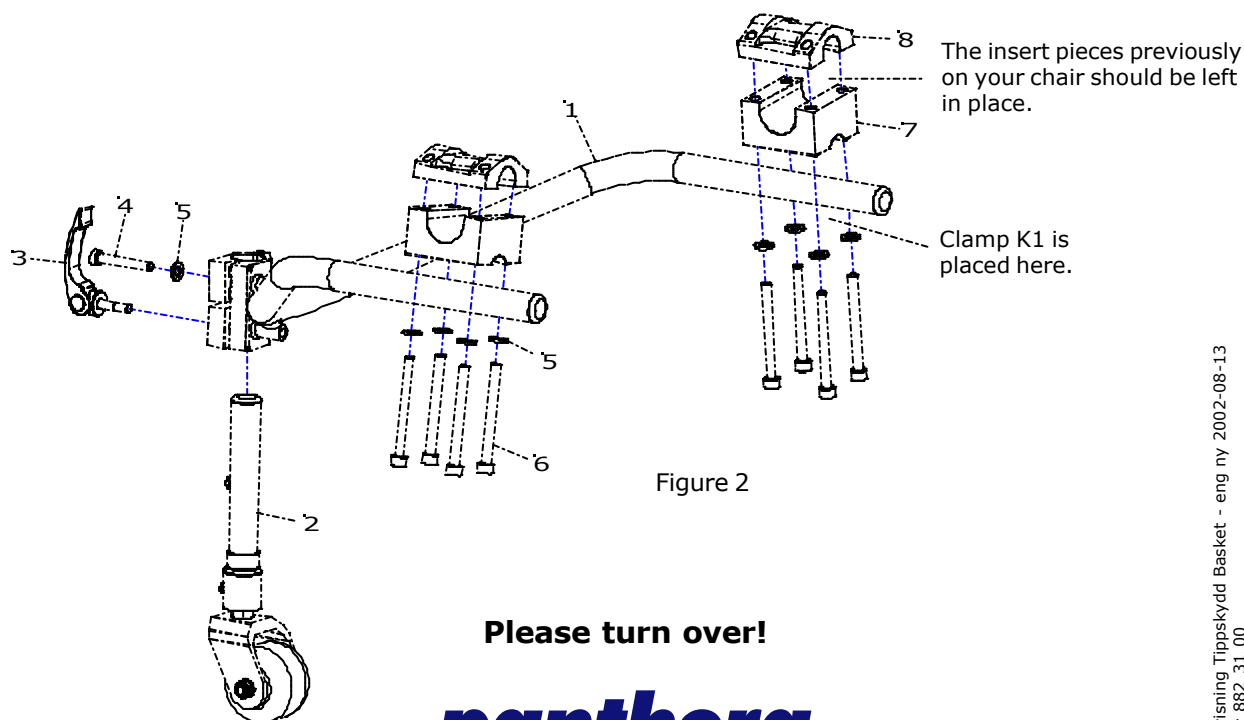

Figure 2

Please turn over!

Instructions for assembly Anti tip device Basket

Raise and lower your tip stop

1. Screw in the safety screw in the wheel tubing (2) in a suitable hole. (See figure 3)
2. Loosen the quick lock (3).
3. Push the wheel tubing up through the hinge clamp located on the curved tubing (1) until you find the best distance between the tip wheel and the floor.
4. Tighten the quick lock.

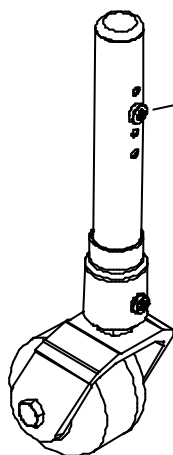

Place the safety screw beneath the hinge clamp (Figure 2). This screw is just an extra safety screw in case you forget to tighten the quick lock. If this should happen, the safety screw fastens in the hinge clamp and prevents you falling backwards.

Figure 3