

Instructions for assembly Plastic side guards, new on chair - width 45

How to assemble your side guards:

1. Start by unscrewing the nut located on the backrest frame bracket of your chair (figure 1) and replace it with a washer (5) and a cog fastener (2) as shown in figure 2. Tighten the cog fastener securely. (When you tighten the cog fastener you should use some form of threading lock, such as Loctite, to prevent the cog unscrewing to become loose).
2. Take both clamps (3) and place them around the seat tubing of the chair. Screw them in place loosely using the small washer (4), the bolt (6), the bigger washers (5) and a fastener cog (2). See figure 2.
3. Push the side guard (1) down into the cog fastener located on the backrest frame bracket and move the front cog fastener forwards or backwards until the side guard also fits into the front cog fastener.
4. Make sure that the side guard is straight and that it is not crooked due to the clamps not being straight.
5. When you have found a position where you can remove and insert the side guard easily and it is straight, tighten the bolt (6) securely.
6. Repeat the procedure on the other side.

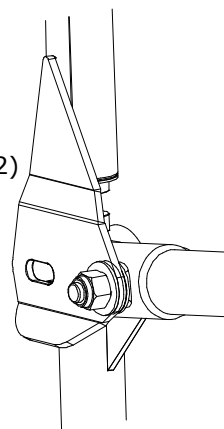

Figure 1

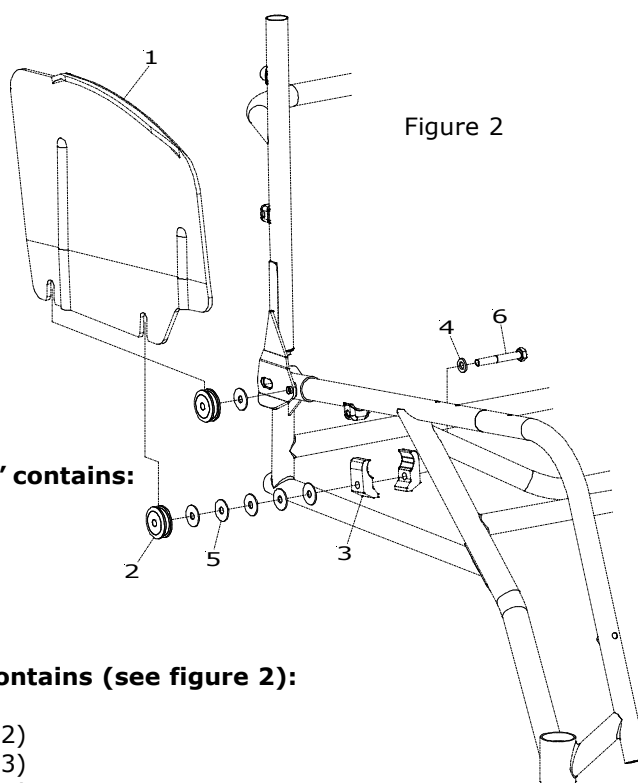

Figure 2

"Sideguards plastic new, complete pair" contains:

- 1 Sideguards plastic right, new model
- 1 Sideguards plastic left, new model
- 1 Attachments sideguards, complete

"Attachments sideguards, complete" contains (see figure 2):

- | | | |
|----|--------------------------|----------|
| 4 | Roll, sideguards | (pos. 2) |
| 4 | Clamp | (pos. 3) |
| 2 | Washer BRB steel, 6,4x12 | (pos. 4) |
| 12 | Washer NB steel 6x19x1 | (pos. 5) |
| 2 | Bolt M6S M6x45 | (pos. 6) |