

Which footrest fits what chair?

By measuring the C-C (A) distance and the distance (B) on each footrest and look in the table below you can find out which wheelchair and which seat width the footrest fits.

V-shape std and extended / reinforced

Fits: S2 / S3, S2 / S3 short, S2 / S3 short-low, S2 / S3 large

Chair width	A	B
		282 = std
36	340	307= extended
39	370	
42	400	
45	430	

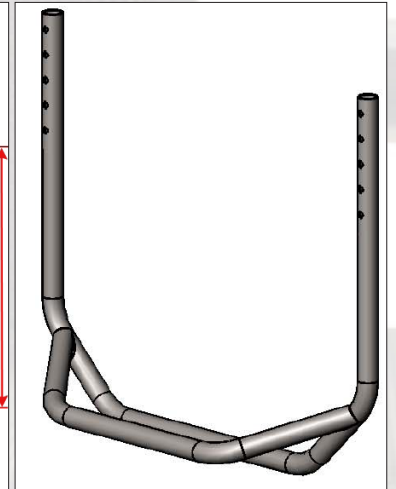
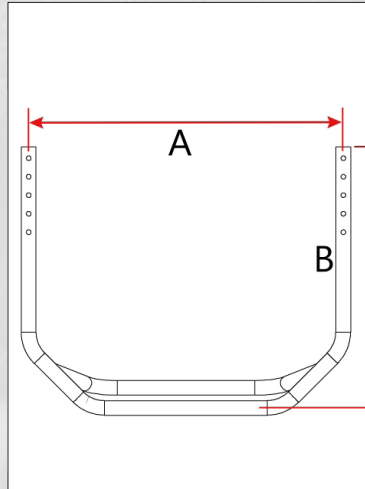

U-shape and extended / reinforced for the U-series

Fits: U2 / U3, U2 / U3 light, X

Chair width	A	B
		260 = std
33	229	285= extended
36	259	
39	289	
42	319	
45	349	

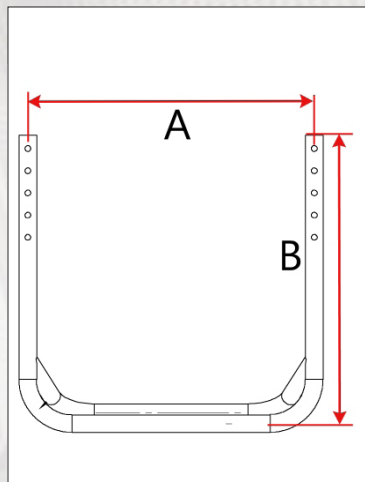

U-shape small heel bow for the U-series

Fits: U2 / U3, U2 / U3 light, X

Chair width	A	B
		260 = std
33	229	
36	259	
39	289	
42	319	
45	349	

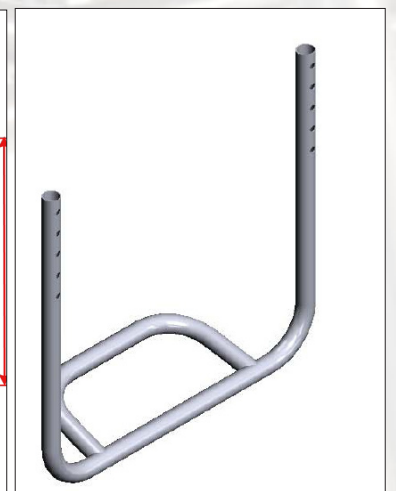
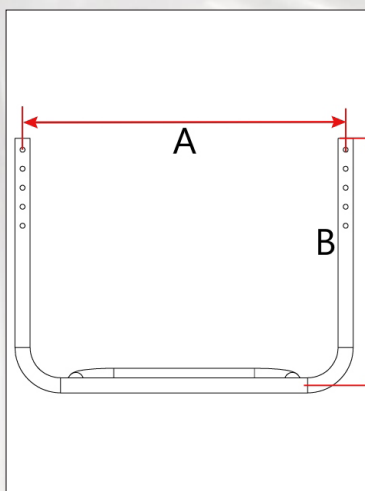

U-shape small heel bow for the S-series

Fits: S2 / S3 (std 30-33 cm), S2 /S3 short (std 30-33 cm), S2 / S3 short-low,

Chair width	A	B
30	280	260 = std
33	310	
36	340	
39	370	

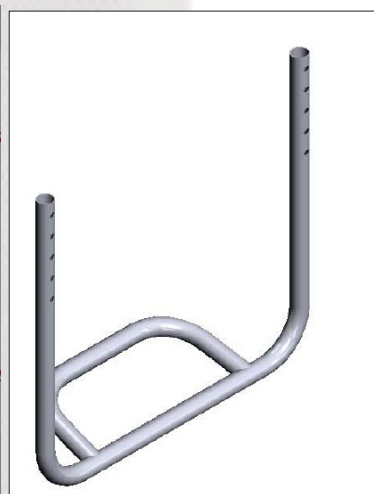
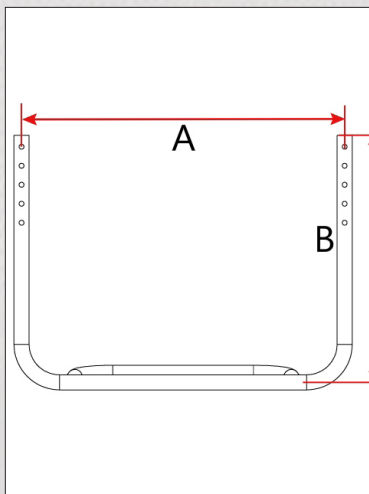

U-form X för U-serien

Lightweight model made in aluminum

Fits: U2 / U3, U2 / U3 light, X

Chair width	A	B
33	229	260 = std
36	259	
39	289	
42	319	
45	349	

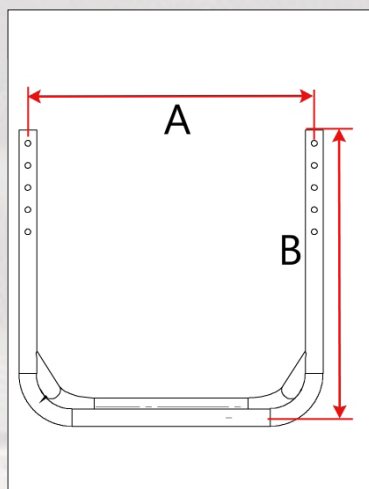

U-form for U3 Light Y90

Adapted heel bow to fit the Y90

Fits: U3 light Y90

Chair width	A	B
33	229	260 = std
36	259	
39	289	
42	319	
45	349	

